





📍 16 Jasmine Close, Calne, SN11 0QN

🏠 £195,000

A beautifully presented one bedroom freehold house, offering stylish, contemporary accommodation; benefitting from a spacious rear garden, and off-road parking for two vehicles. This wonderful property would make the perfect first home, and is offered with No Onward Chain.

- One Bedroom House, Freehold
- No Onward Chain
- Beautifully Presented Throughout
- Modern Open-Plan Living
- Beautifully Appointed Kitchen & Bathroom
- Large Double Bedroom
- Well-Proportioned, Enclosed Rear Garden
- Off-Road Parking for Two Vehicles
- Ideal First Home
- Quiet & Popular Cul-De-Sac

🏠 Freehold

🏠 EPC Rating D





Tucked away in a quiet, sought-after cul-de-sac just moments from the Town Centre, this stunning one-bedroom home has been meticulously updated for modern living. Perfect for first-time buyers or savvy investors, this wonderful home is stylish, contemporary and ready to move into, and if offered with the added benefit of No Onward Chain.

The heart of the home is a bright, open-plan kitchen / living area, featuring a sleek, recently fitted kitchen complete with integrated appliances (oven, hob, fridge, and freezer). Upstairs, you'll find a spacious double bedroom and a superb, high-specification bathroom.

Step outside to a private, low maintenance rear garden, with a patio terrace and artificial lawn. With rear access leading directly to the allocation off-road parking for two cars.

#### **Situation**

Jasmine Close is situated on the Southern fringes of Calne, which provides a comprehensive range of amenities including a choice of shops and supermarkets, public library, churches and schooling for all age groups. Calne is an expanding north Wiltshire town within easy travelling distance of nearby larger centres which include Chippenham (6 miles) and Swindon (18 miles). Junctions 16 and 17 of the M4 Motorway are both easily accessible from the town, whilst a mainline railway station at Chippenham provides regular services to London Paddington. For those with recreational interests there are golf courses at North Wilts and Bowood, riding at Hampsley Hollow and fishing and walks at Blackland Lakes. There are also the archaeological sites of Avebury Stone Circle, Kennet Long Barrow and Silbury Hill within easy travelling distance.

#### **Property Information**

Council Tax Band: A

Tenure: Freehold

Mains Electricity, Water & Drainage

Electric Heating

EPC Rating; D



## Jasmine Close, Calne, SN11

Approximate Area = 454 sq ft / 42.1 sq m

For identification only - Not to scale

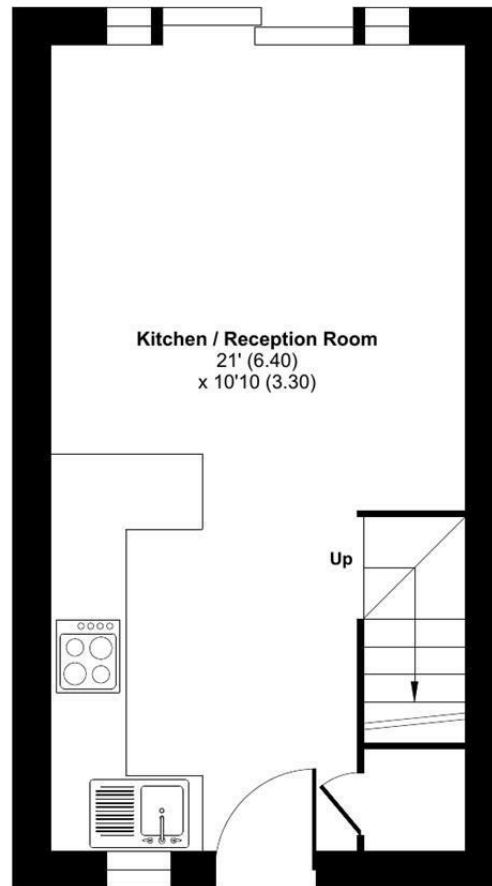

GROUND FLOOR

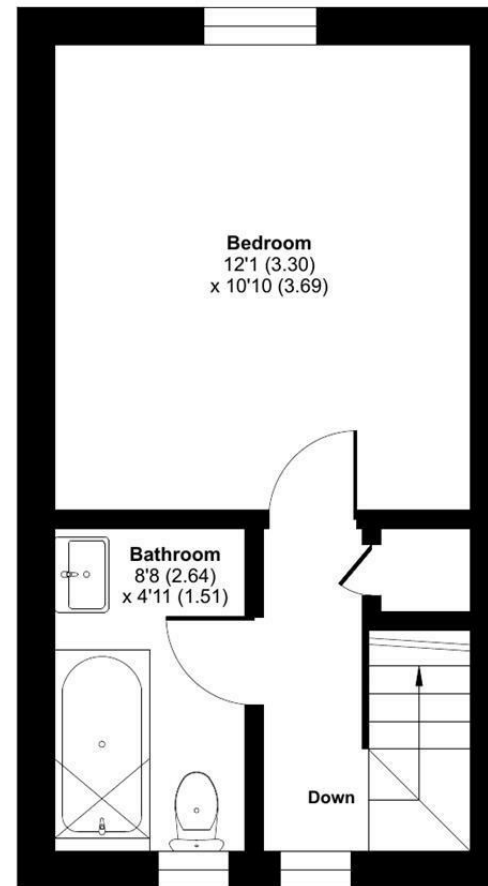

FIRST FLOOR



Floor plan produced in accordance with RICS Property Measurement 2nd Edition, Incorporating International Property Measurement Standards (IPMS2 Residential). © nichecom 2026. Produced for Strakers. REF: 1403768

Disclaimer These particulars, whilst believed to be accurate are set out as a general outline only for guidance and do not constitute any part of an offer or contract. Intending purchasers should not rely on them as statements of representation of fact, but must satisfy themselves by inspection or otherwise as to their accuracy. No person in this firm's employment has the authority to make or give any representation or warranty in respect of the property. All measurements and distances are approximate only. Your home is at risk if you do not keep up repayments on a mortgage or other loan secured on it.